

NOTES:

Current Rating:0.5AMP
 Contact Resistance:30mΩ max
 Withstand Voltage:100V AC/DC
 Insulation Resistance:500MΩ min
 Operation Temperature:-40°C to +125°C

Contact Material:Phosphor Bronze
 Cap Material:Sn1=0.25mm
 Housing Material:CP(U94V-0) Noture
 Contact plating:Au and Tin over Ni

Fittness: <80Pins The "M" is 0.12mm MAX
 ≥80Pins The "M" is 0.15mm MAX

Ordering Information

3616-S XXXX -037 XX R 01

No. of Pins Housing High Contact Fining R-Type/keel-CAP
 SI-S/Cold/Tin SI-S/Cold/Tin
 SP-S/Cold/Tin
 ΔA

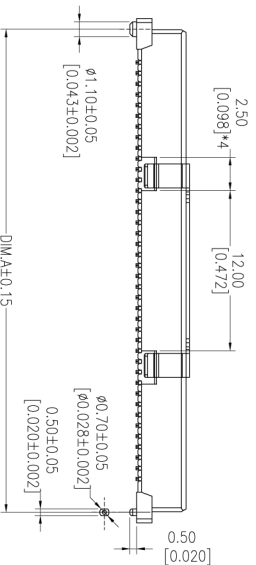
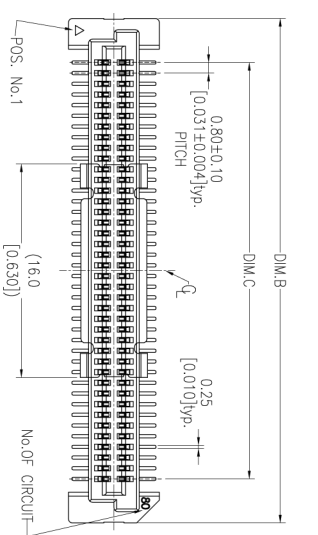

Recommended P.C.B Layout (Top Side)
(PCB BOARD TOLERANCE ± 0.05)

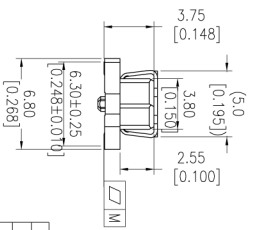
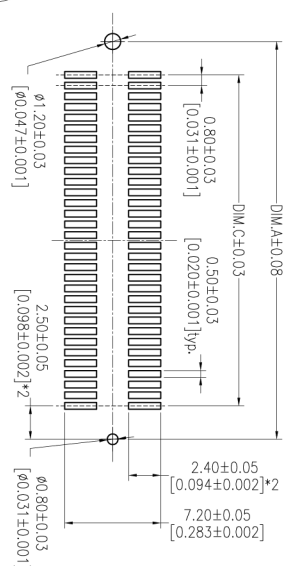

79.20	85.80	84.20	200
71.20	77.80	76.20	180
63.20	69.80	68.20	160
55.20	61.80	60.20	140
47.20	53.80	52.20	120
39.20	45.80	44.20	100
31.20	37.80	36.20	80
23.20	29.80	28.20	60
15.20	21.80	20.20	40
DIM.C	DIM.B	DIM.A	PIN NO.

上海回峰电子科技有限公司
 Shanghai Hui Feng Electronic Technology Co., Ltd

电话: 021-67150229
 传真: 021-67150251
 企业邮箱: hui Feng_dzki@163.com
 公司网址: www.hui Feng-china.com

		OPERATION	DRAW	DATE	SCALE	FIT	PART NO.
		XXX	△/len	2014/11/07	mm		3616-SXXX-037XXR01
		XXX	CHECK	DATE	UNIT	inch	TITLE: 0.80mm B TO B Female
A1	2014/11/07	Modify	△	DATE	SIZE	A4	H=3.75 "T" TYPE SMT
A0	2014/06/24	NEW	XXX	DATE	SHEET	1/2	Customer NO.
REV	DATE	MODIFICATION DESCRIPTION	CHANGE	DATE	PROJ.		